

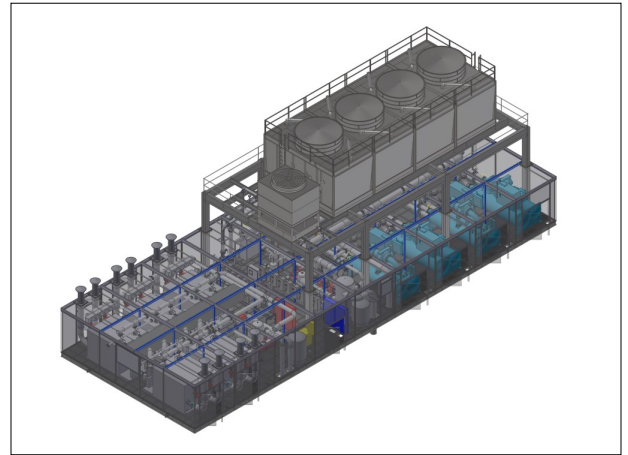

- Date:** 2015
- Project Description:** Modular central plant for a resort and casino.
- Scope Performed:** Project management, design, along with approximately 8700 labor hours to assemble.
- Delivery Method:** Design-Build
- Contract Value:** \$4.9 Million



Major Components

- (3) 800 ton centrifugal chillers, TOTAL 2400 tons chilled water system, variable speed, with matching cooling towers, pumping and controls
- (8) Condensing Boilers, 6000MBH each, TOTAL 48,000 MBH
- (3) Chilled water pumps, 6000 Total GPM
- (3) Condenser Water Pumps, 6600 Total GPM
- (2) Glycol pumps, 740 Total GPM
- (2) Hot Water pumps, 4000 Total GPM
- (1) Closed Circuit Fluid Cooler, 320 GPM
- Power panels and VFDs
- Enclosure

